

RERA REG. NO. : RAJ/P/2025/4280

www.rera.rajasthan.gov.in



ARANYAA

Where nature meets luxury



M G REALINFRA PVT. LTD.

www.mgrealinfra.com



ARANYAA

2 & 3 BHK Luxury Apartments

Welcome to Aranyaa.

An exclusive address where luxury living harmonizes with nature's elegance. Nestled amidst lush greenery, it is more than just a residence — it's a lifestyle crafted for those who value peace, sophistication, and timeless beauty.

Designed with an eye for detail and a vision for excellence, it combines modern architecture, sustainable planning, and premium amenities to create an unparalleled living experience. Every corner reflects refinement, while every view opens to green landscapes, ensuring you live close to nature without compromising on luxury.

At Aranyaa, we believe that true luxury is not only in grand designs but also in the serenity, privacy, and comfort it brings. This is why it's envisioned as a sanctuary — a home where life blossoms naturally, and every moment feels extraordinary.

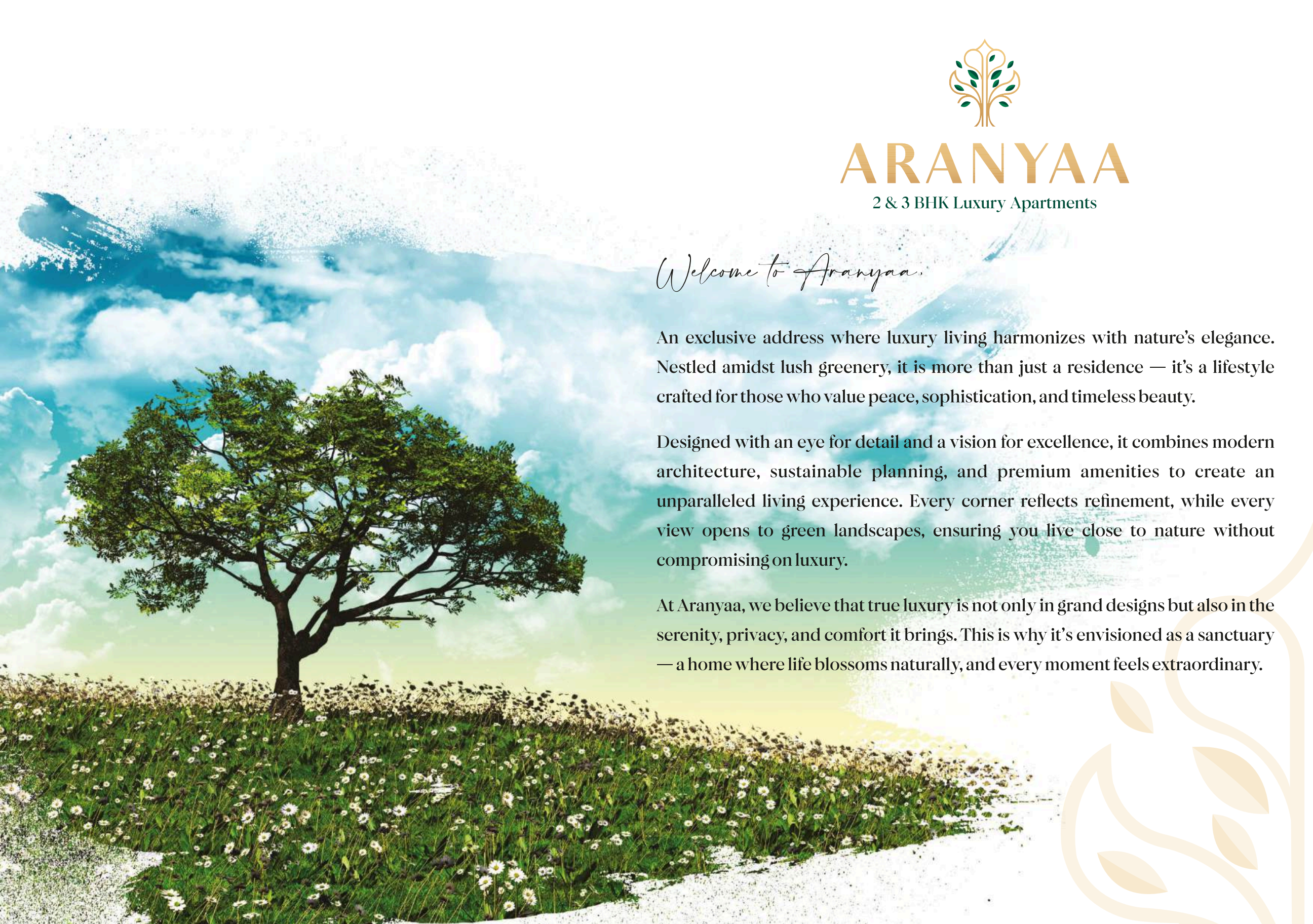

You Never Knew
Life could be so
vibrant yet
Peaceful



110 Keys

- 2 & 3 BHK
- Environment Friendly
- Luxury Apartments



Ecosystem

- Rain Water Harvesting
- Lush Green Terrace Area
- Exotic Garden Area
- Jogging Track



Features

- Premium Fittings
- Ample Parking Space
- 24 Hours Water Supply
- Gazebo/Senior Citizen Area
- Well Designed Entrance Lobby
- 3 High Speed Elevators
- 100% Power Backup for Common Area





A life
where family
meets peace
& joy,
in the heart
of the city.



Discover a residence where every moment celebrates togetherness. Set in the heart of the city yet surrounded by serenity, it offers the perfect balance of urban convenience and peaceful living. More than just a home, it's a haven designed for families who seek comfort, joy, and a life of lasting harmony.





Establishing pathways
to a happy life

Sit in with nature.
Because the sit-out is so inviting,
that you wouldn't want to sit inside. Works?

Unit & Floor Plans



Our
design experts
have plans for you



Stilt Floor Plan

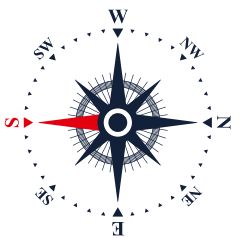
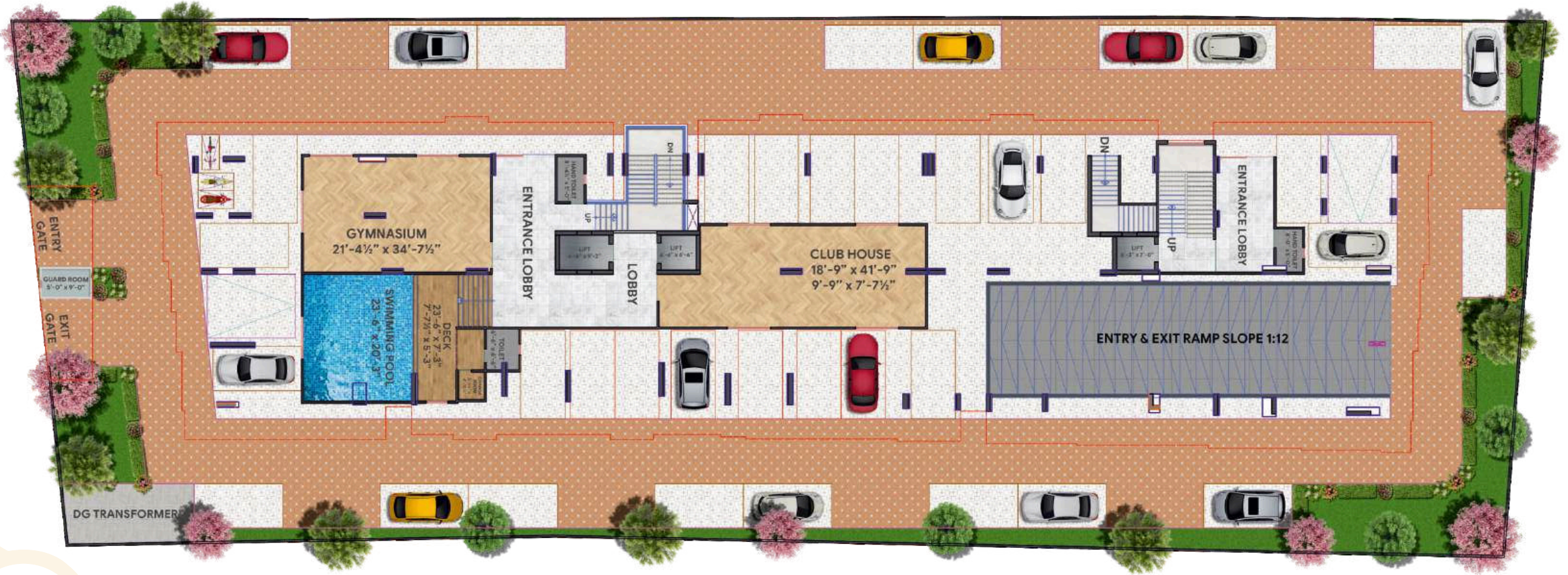



First Floor Plan

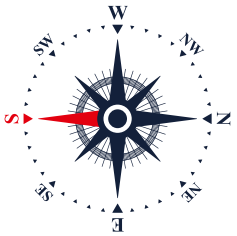

UNIT NO.	TYPE	CARPET AREA	BUILT UP AREA	SBU AREA
101	3 BHK	913.28 Sq.Ft.	1100 Sq.Ft.	1540 Sq.Ft.
102	3 BHK	911.88 Sq.Ft.	1106.53 Sq.Ft.	1550 Sq.Ft.
103	3 BHK	926.52 Sq.Ft.	1094.52 Sq.Ft.	1532 Sq.Ft.

UNIT NO.	TYPE	CARPET AREA	BUILT UP AREA	SBU AREA
104	3 BHK	967.21 Sq.Ft.	1195.35 Sq.Ft.	1674 Sq.Ft.
105	3 BHK	958.39 Sq.Ft.	1130.79 Sq.Ft.	1584 Sq.Ft.
106	3 BHK	879.37 Sq.Ft.	1062.86 Sq.Ft.	1488 Sq.Ft.



UNIT NO.	TYPE	CARPET AREA	BUILT UP AREA	SBU AREA
107	3 BHK	963.23 Sq.Ft.	1131.29 Sq.Ft.	1584 Sq.Ft.
108	3 BHK	909.84 Sq.Ft.	1052.10 Sq.Ft.	1473 Sq.Ft.
109	3 BHK	898.53 Sq.Ft.	1034.75 Sq.Ft.	1449 Sq.Ft.

UNIT NO.	TYPE	CARPET AREA	BUILT UP AREA	SBU AREA
110	2 BHK	566.76 Sq.Ft.	678.83 Sq.Ft.	950 Sq.Ft.
111	2 BHK	566.76 Sq.Ft.	683.57 Sq.Ft.	957 Sq.Ft.



Flat 01

TYPE 3 BHK

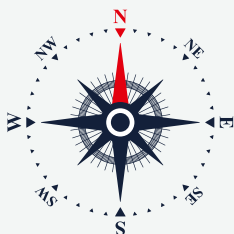

UNIT NO.	TYPE	CARPET AREA	BUILT UP AREA	SBU AREA
101	3 BHK	913.28 Sq.Ft.	1100 Sq.Ft.	1540 Sq.Ft.

02	03	04	05	06
01	11	10	09	08
				07



Flat 02

TYPE 3 BHK



02	03	04	05	06
01	11	10	09	08

UNIT NO.	TYPE	CARPET AREA	BUILT UP AREA	SBU AREA
102	3 BHK	911.88 Sq.Ft.	1106.53 Sq.Ft.	1550 Sq.Ft.





Flat 03

TYPE 3 BHK

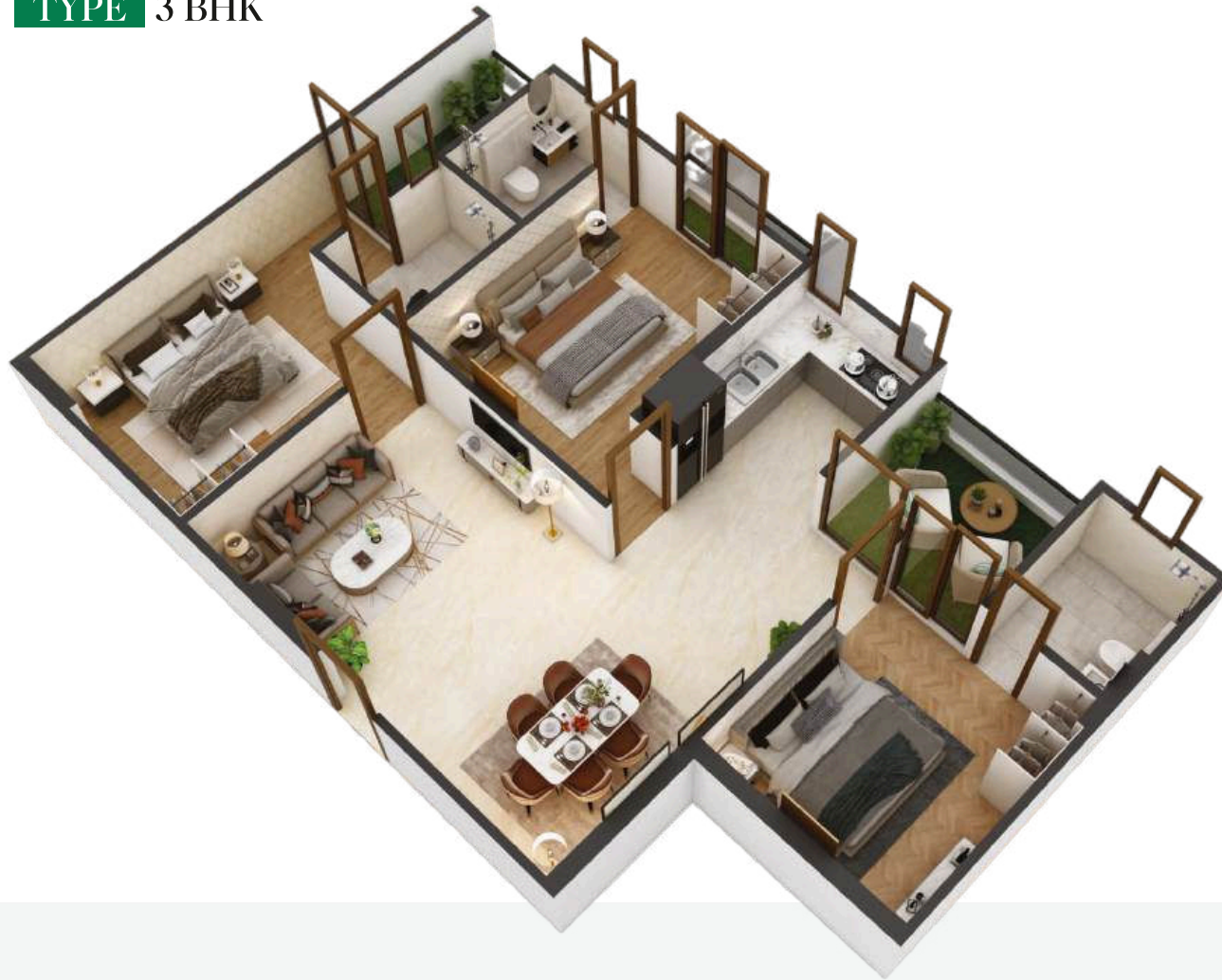

UNIT NO.	TYPE	CARPET AREA	BUILT UP AREA	SBU AREA
103	3 BHK	926.52 Sq.Ft.	1094.52 Sq.Ft.	1532 Sq.Ft.

02	03	04	05	06
01	11	10	09	08
				07



Flat 04

TYPE 3 BHK



02	03	04	05	06
01	11	10	09	08

UNIT NO.	TYPE	CARPET AREA	BUILT UP AREA	SBU AREA
104	3 BHK	967.21 Sq.Ft.	1195.35 Sq.Ft.	1674 Sq.Ft.

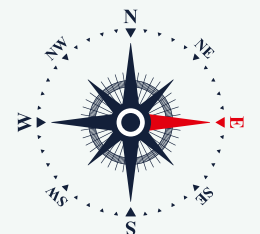



Flat 05

TYPE 3 BHK

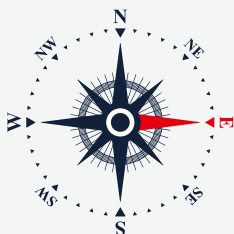

UNIT NO.	TYPE	CARPET AREA	BUILT UP AREA	SBU AREA
105	3 BHK	958.39 Sq.Ft.	1130.79 Sq.Ft.	1584 Sq.Ft.

02	03	04	05	06
01	11	10	09	08
				07

Love
where
you
live.





Flat 06

TYPE 3 BHK

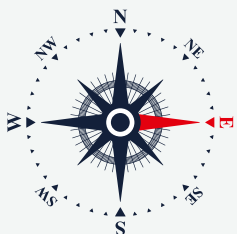
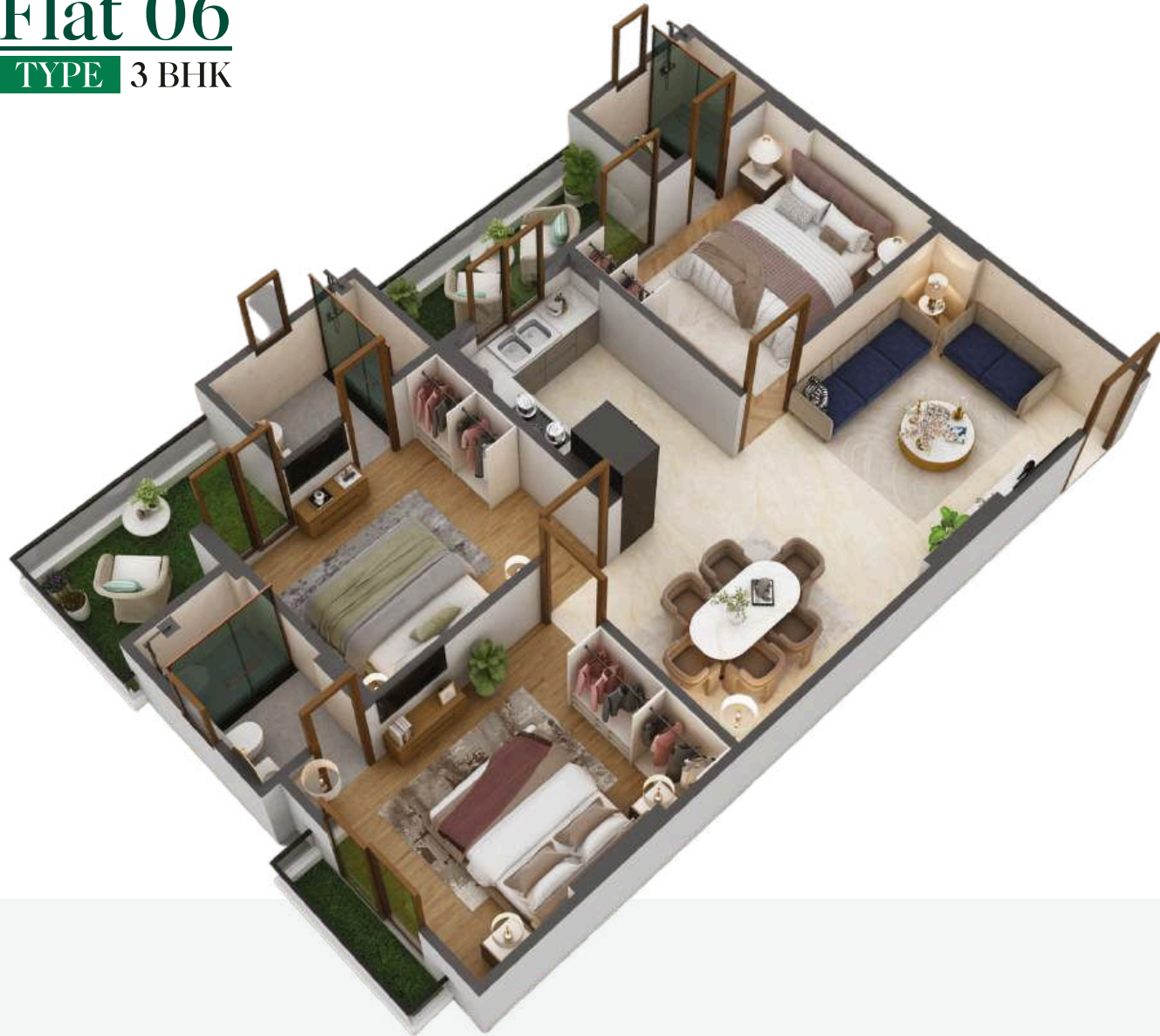

UNIT NO.	TYPE	CARPET AREA	BUILT UP AREA	SBU AREA
106	3 BHK	879.37 Sq.Ft.	1062.86 Sq.Ft.	1488 Sq.Ft.

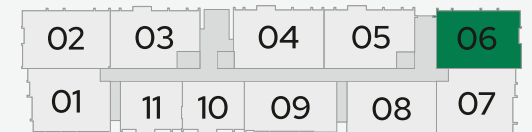



Flat 07

TYPE 3 BHK

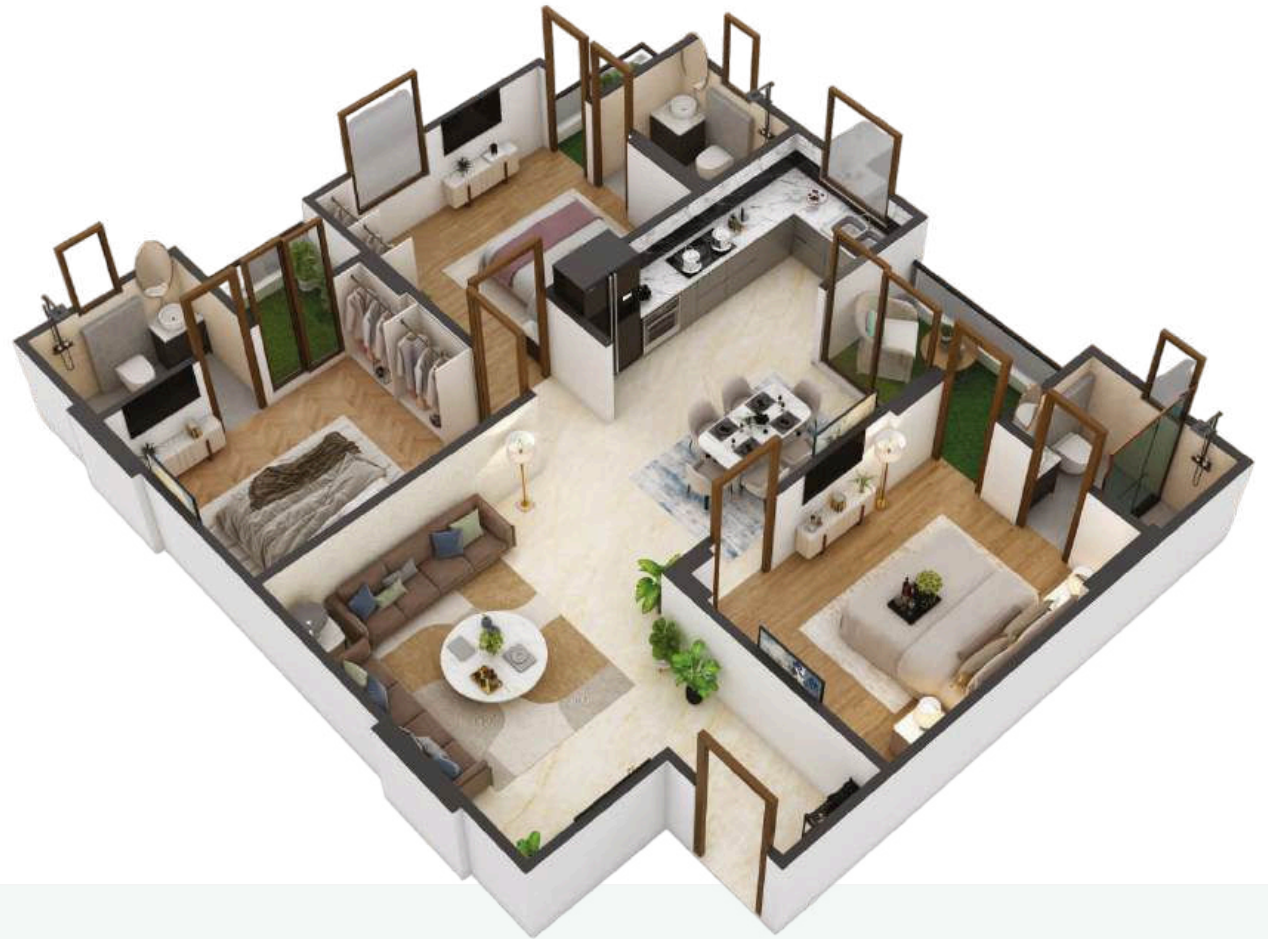

02	03	04	05	06
01	11	10	09	08
				07

UNIT NO.	TYPE	CARPET AREA	BUILT UP AREA	SBU AREA
107	3 BHK	963.23 Sq.Ft.	1131.29 Sq.Ft.	1584 Sq.Ft.

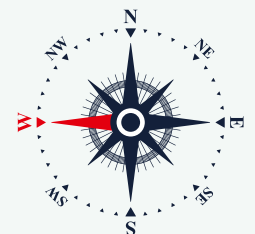



Flat 08

TYPE 3 BHK

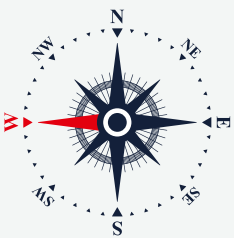

UNIT NO.	TYPE	CARPET AREA	BUILT UP AREA	SBU AREA
108	3 BHK	909.84 Sq.Ft.	1052.10 Sq.Ft.	1473 Sq.Ft.





Flat 09

TYPE 3 BHK



02	03	04	05	06
01	11	10	09	08
				07

UNIT NO.	TYPE	CARPET AREA	BUILT UP AREA	SBU AREA
109	3 BHK	898.53 Sq.Ft.	1034.75 Sq.Ft.	1449 Sq.Ft.

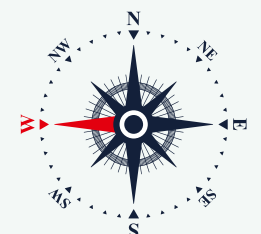



Flat 10

TYPE 2 BHK

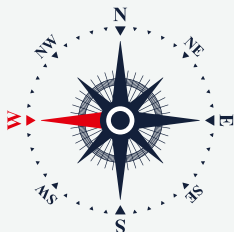

UNIT NO.	TYPE	CARPET AREA	BUILT UP AREA	SBU AREA
110	2 BHK	566.76 Sq.Ft.	678.83 Sq.Ft.	950 Sq.Ft.

02	03	04	05	06
01	11	10	09	08
				07



Flat 11

TYPE 2 BHK



02	03	04	05	06
01	11	10	09	08

UNIT NO.	TYPE	CARPET AREA	BUILT UP AREA	SBU AREA
111	2 BHK	566.76 Sq.Ft.	683.57 Sq.Ft.	957 Sq.Ft.

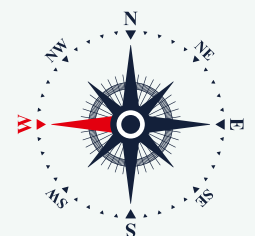



Terrace Floor Plan

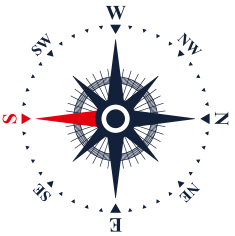

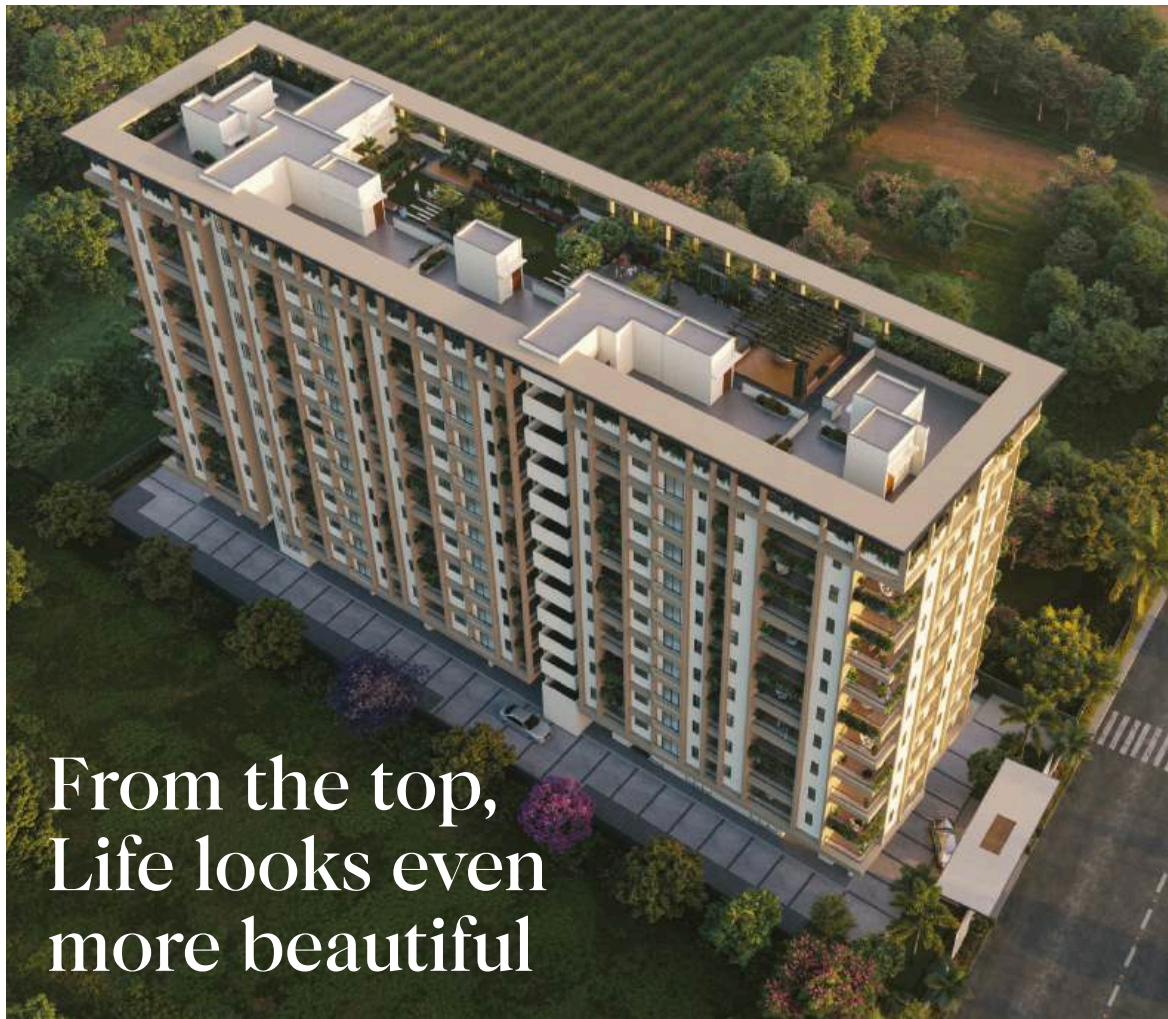

From the top,
Life looks even
more beautiful





the
Perfect
place for your
Family



Where
Luxury
lives in harmony with
Nature

As you cross this iconic gateway, you're not just entering a building — you're stepping into a thoughtfully designed lifestyle. Surrounded by lush greenery, this serene space is crafted for those who value elegance, comfort, and a deeper connection with nature. The grand entrance itself reflects the promise of luxury that lies within.





AMENITIES
that redefine everyday
LIVING

Lobby Area



Banquet Hall



Swimming Pool



Gymnasium

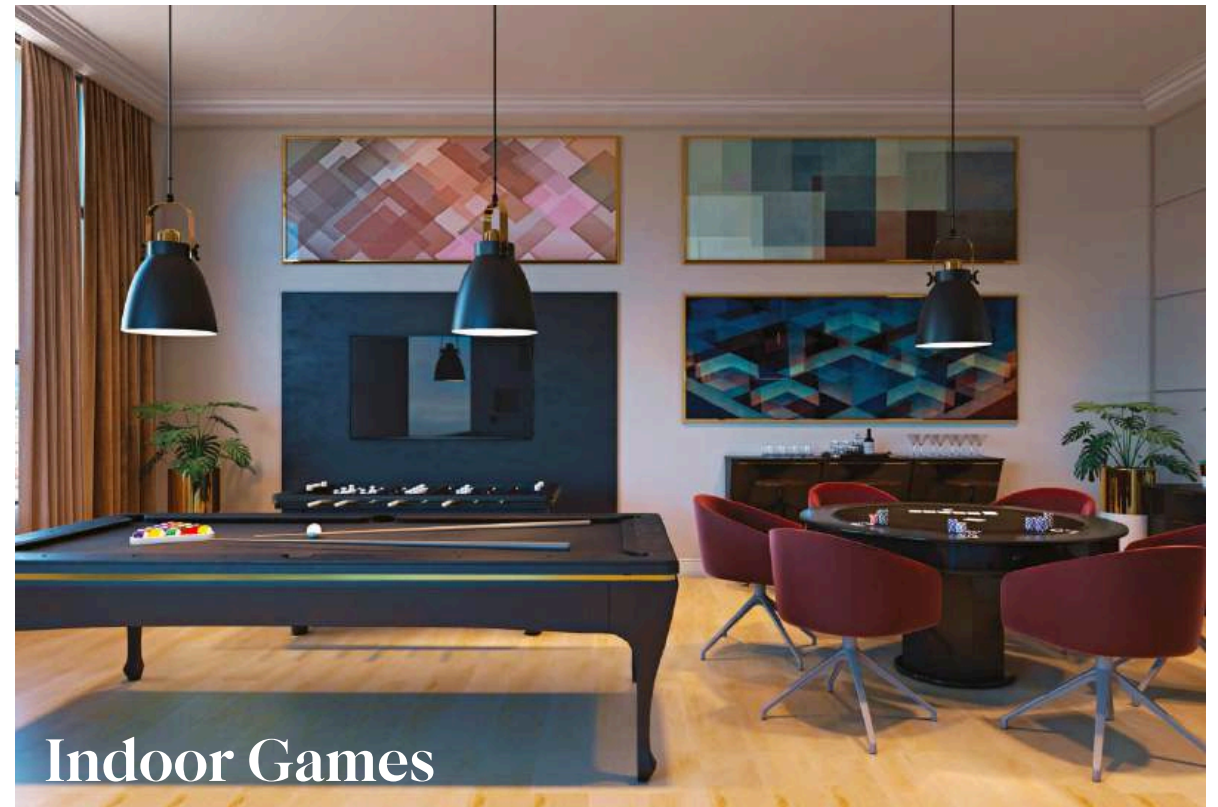

Indoor Games



Kids Play Area



Open Air Theater



Steam Bath



Ample Parking Space

SPECIFICATIONS

Crafted with care, built to last.



DOORS & WINDOWS

- Outer door & windows of UPVC/Aluminium with toughened glass.
- Wooden designer laminated doors.
- Standard quality hardware & fittings with S.S. Finish.



FLOORING

- Granite flooring in common areas.
- Vitrified tile flooring in drawing, dining & bedrooms.
- Ceramic tile flooring in toilets & balconies.



LIFT

- 3 Separate lifts (2 Passenger lift & 1 Service lift).
- All lifts equipped with automatic rescue device.



TOILETS

- Ceramic digital wall tiles up to fall ceiling height.
- Ceramic sanitary ware of Jaquar/Kohler/Cera or equivalent.
- CP bath fittings of Jaquar/Kohler/Cera or equivalent.



LOCATION ADVANTAGE

- Situated at prime location of Jagatpura.
- Situated in developed area having public transport and all other amenities.
- Near NIMS hospital, Jagatpura.
- Five minute drive from Khatipura railway station.
- Renowned schools, colleges and hospitals nearby.
- Near D-Mart.



KITCHEN

- Kitchen with granite counter top.
- Ceramic digital tiles up to 2 ft. height.
- Stainless steel kitchen sink of standard make.
- Semi modular kitchen with overhead cabinets.



ELECTRICAL

- Electrical modular switches & fittings of Havells/RR/Honeywell or equivalent.
- All wiring in copper pvc multi strand wires of RR Kabel/Kej/Microtek or equivalent.
- Tv points in all rooms.
- Split A.C. piping/wiring.



SECURITY

- 24/7 Security.
- Boom barrier.
- CCTV.
- Community application & gate entry.
- MS/SS door entry.



WATER MANAGEMENT

- 24 hours water supply system.
- Rain water harvesting system for ground water recharge.
- STP Plant.





A
Dream That
Glitters Even
After Sunset



Step into a lifestyle that shines day and night. With its striking architecture, modern comforts, and serene surroundings, this address becomes a landmark even after the sun sets. Designed for those who aspire for elegance and exclusivity, it offers not just a home, but a glowing statement of refined living.

Location Map

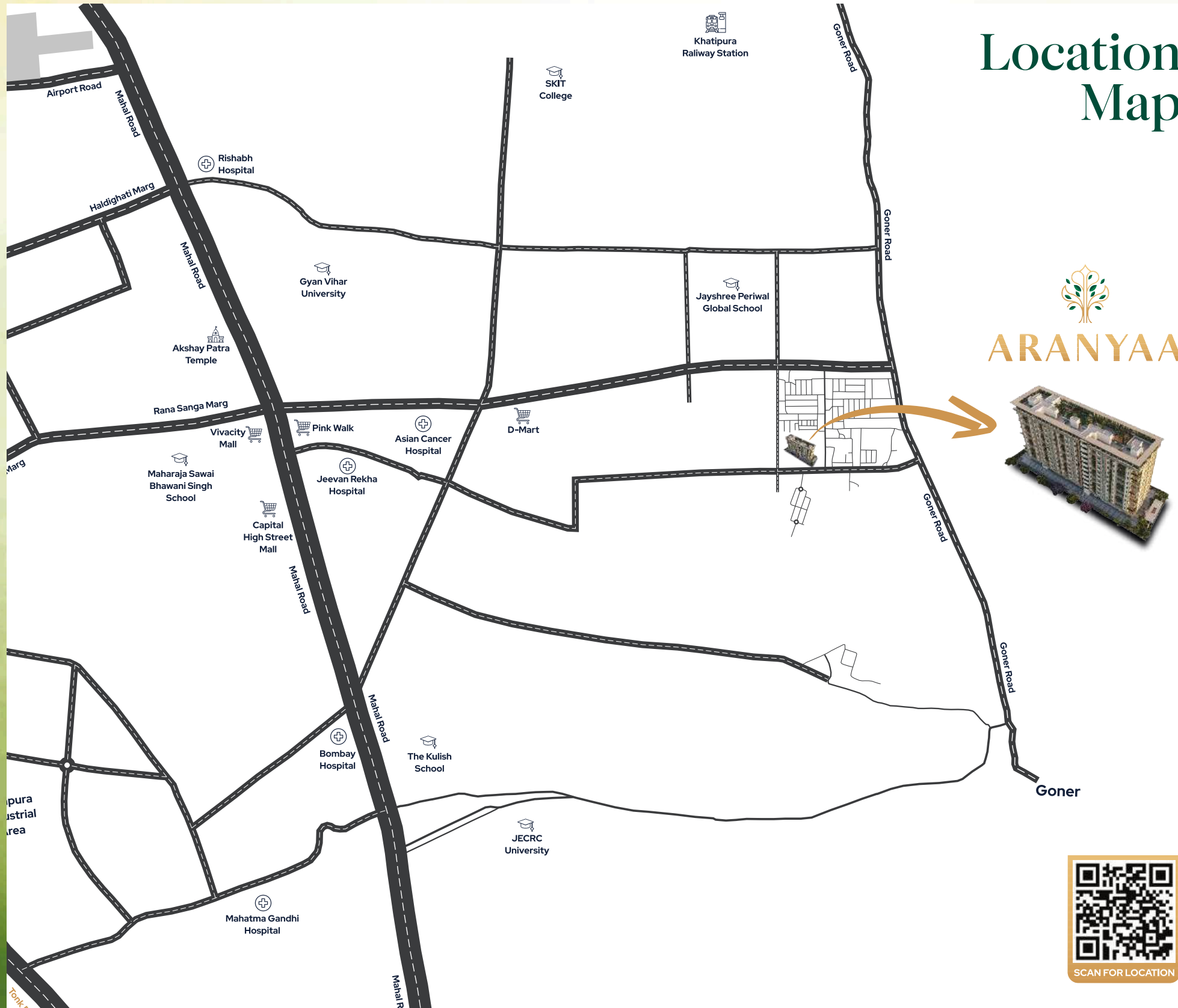

ARANYAA



SCAN FOR LOCATION



EDUCATION

- Jayshree Periwal Global School - 1 Km
- Maharaja S.B.S. School - 4.5 Km
- Gyan Vihar University - 4 Km
- JECRC University - 3 Km
- The Kulish School - 3.5 Km
- SKIT College - 4 Km



HEALTH

- Bombay Hospital - 4 Km
- Jeevan Rekha Hospital - 4 Km
- Mahatma Gandhi Hospital - 5.5 Km
- Rishabh Hospital - 5 Km
- Asian Cancer Hospital - 3 Km



SHOPPING

- Pink Walk - 4 Km
- Capital High street (R-Tech) - 4 Km
- D Mart - 2 Km
- Viva City Mall - 4 Km



TRANSPORT

- Airport - 10 Km
- Khatipura Railway Station - 4 Km
- Jagatpura Railway Station - 8 Km



TEMPLE

- Akshaya Patra - 4 Km



ARANYAA

Builders & Developers :



Office Address

Plot No.240, Nandpuri-B, Jagatpura, Jaipur, Rajasthan-302033

E Mail

mgrealinfra@gmail.com

Website

www.mgrealinfra.com

Site Address

Aranyaa,

Plot Khasara No.-3477/2444, At Village - Siroli, Tehsil - Sanganer, Jagatpura, Jaipur, Rajasthan, India

Rera Reg. No. : RAJ/P/2025/4280 | Rera Website : www.rera.rajasthan.gov.in



Rera Registered

